



2855 STEVENS CREEK BLVD. SUITE 2160
SANTA CLARA, CA 95050

DRAWING NO
E047829 REV 4



BRAND APPROVAL		LANDLORD APPROVAL	
_____	_____	_____	_____
BRAND APPROVAL	DATE	LANDLORD APPROVAL	DATE
THIS DRAWING SUPERSEDES ALL OTHER DOCUMENTS PROVIDED CONCERNING THE FABRICATION AND INSTALLATION OF THIS DESIGN. A SIGNATURE ANYWHERE ON THIS DRAWING WILL BE TAKEN AS APPROVAL OF THE DESIGN AND SPECIFICATIONS AS NOTED.			

REVISIONS

DATE:	REVISIONS & DESCRIPTION	DESIGNER
01/08/25	1. UPDATE SIZES FOR SIGNS 1.0 & 2.0	BP
01/20/25	2. UPDATE 1.0, 2.0, & 3.0. REMOVE 4.0, 5.0, & 6.0.	BP
01/31/25	3. UPDATE FABRICATION PLANS FOR 1.0 & 2.0.	BP
02/20/25	4. UPDATE BASED ON LL REQUESTS.	BP



SUMMARY OF SIGNAGE

SIGN	GRAPHIC	DESCRIPTION	FT²
1.0		- FACE ILLUMINATED CABINET - PUSH THRU GRAPHICS - (QTY 1) ONE REQUIRED	107.18
2.0		- FACE ILLUMINATED CABINET - PUSH THRU GRAPHICS - (QTY 1) ONE REQUIRED	107.18
3.0		- FACE ILLUMINATED CABINET - PUSH THRU GRAPHICS - INTERIOR WALL - (QTY 1) ONE REQUIRED	72.58

SIGNS 4.0, 5.0, & 6.0 REMOVED FROM SCOPE

COLORS

 C1
BLACK

 C2
WHITE

CODE

Zone: Regional Commercial

Wall Signs: 32 sq ft; or one square foot per lineal foot of structure frontage, whichever is greater, up to a maximum sign area of 150 sq ft. One wall sign per primary frontage. Interior signed within the enclosed mall only needs a building permit.

Ground Signs: Existing- panel on SC sign per LL.

Permit Processing Time: 30 Days from date of submittal.

LOCATION PLAN

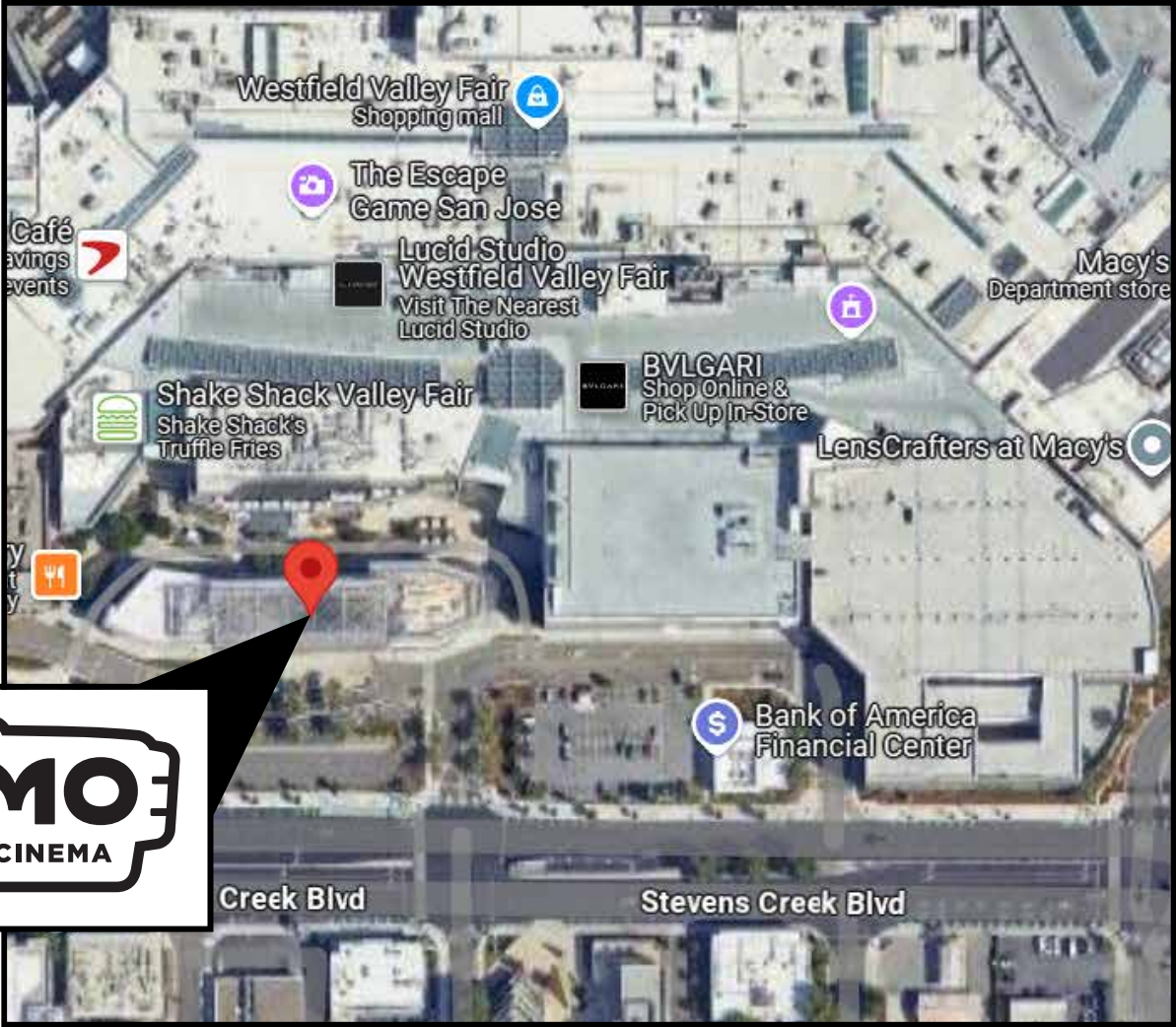

DRAWING NO.

E047829

DATE OF
LAST CHANGE:

02/20/25

ADDITIONAL INSTALL NOTES:

CONSULTANT:
J WELCH
PROJECT MANAGER:
D BELINGER
DESIGNER:
B PARRISH

SITE/
SUM

REVISION NO.

4

FILE LOCATION:
COMPANY/ALAMO DRAFTHOUSE CINEMA/DOCUMENTS/PROJECTS/CURRENT
PROJECTS/CA/ E047829-SANTA CLARA/11 PRODUCTION FILES

PAGE:

1

ASG
ADVANCE SIGN GROUP



800.861.8006
ADVANCESIGNGROUP.COM

2855 STEVENS CREEK BLVD., SANTA CLARA, CA 95050

SITE MAP

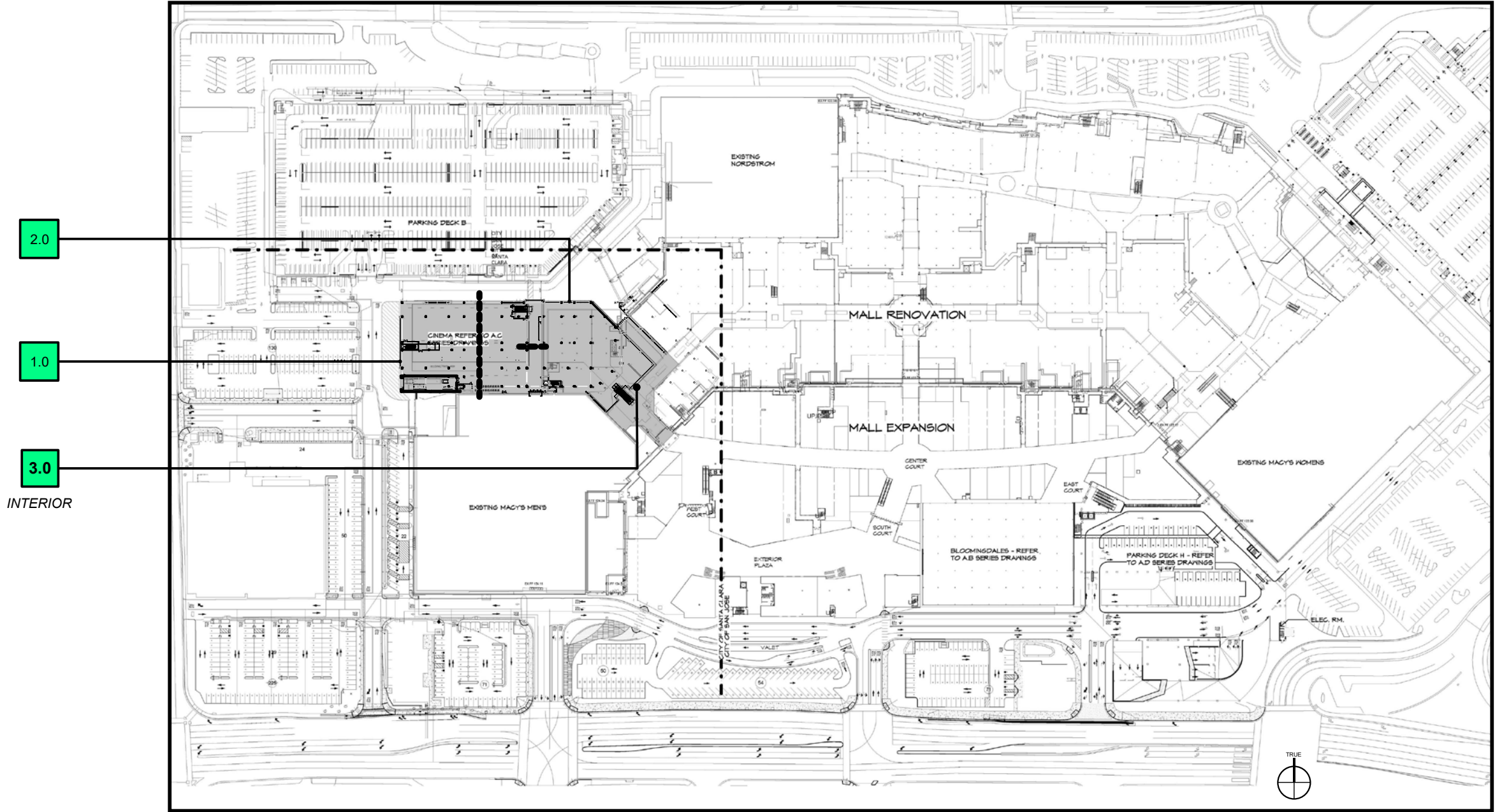

SCALE: NTS



DRAWING NO.

E047829

DATE OF
LAST CHANGE:

02/20/25

ADDITIONAL INSTALL NOTES:

SITE/
SUM

REVISION NO.

4

FILE LOCATION:
COMPANY/ALAMO DRAFTHOUSE CINEMA/DOCUMENTS/PROJECTS/CURRENT
PROJECTS/CA/ E047829-SANTA CLARA/11 PRODUCTION FILES

CONSULTANT:
J WELCH
PROJECT MANAGER:
D BELINGER
DESIGNER:
B PARRISH

PAGE:

2



800.861.8006
ADVANCESIGNGROUP.COM

2855 STEVENS CREEK BLVD., SANTA CLARA, CA 95050

ELEVATION

WEST ELEVATION _ 1.0

SCALE: 1/16" = 1'-0"



- NOTES:**
- SIGN LOCATIONS MAY VARY SLIGHTLY BASED ON ENGINEERING.
 - MOUNTING TO BE DETERMINED BASED ON DETAILED SURVEY OF BUILDING CONSTRUCTION AND ENGINEERING.

FIELD SURVEY REQUIRED

All dimensions are estimated and subject to change upon confirmation of field conditions.



DRAWING NO.
E047829

DATE OF
LAST CHANGE:
02/20/25

ADDITIONAL INSTALL NOTES:

CONSULTANT:
J WELCH
PROJECT MANAGER:
D BELINGER
DESIGNER:
B PARRISH

2855 STEVENS CREEK BLVD., SANTA CLARA, CA 95050

ELEV

REVISION NO.
4

FILE LOCATION:
COMPANY/ALAMO DRAFTHOUSE CINEMA/DOCUMENTS/PROJECTS/CURRENT
PROJECTS/CA/ E047829-SANTA CLARA/11 PRODUCTION FILES

PAGE:

3

ASG
ADVANCE SIGN GROUP



800.861.8006
ADVANCESIGNGROUP.COM

ELEVATION

SOUTH ELEVATION _ 2.0

SCALE: 1/16" = 1'-0"

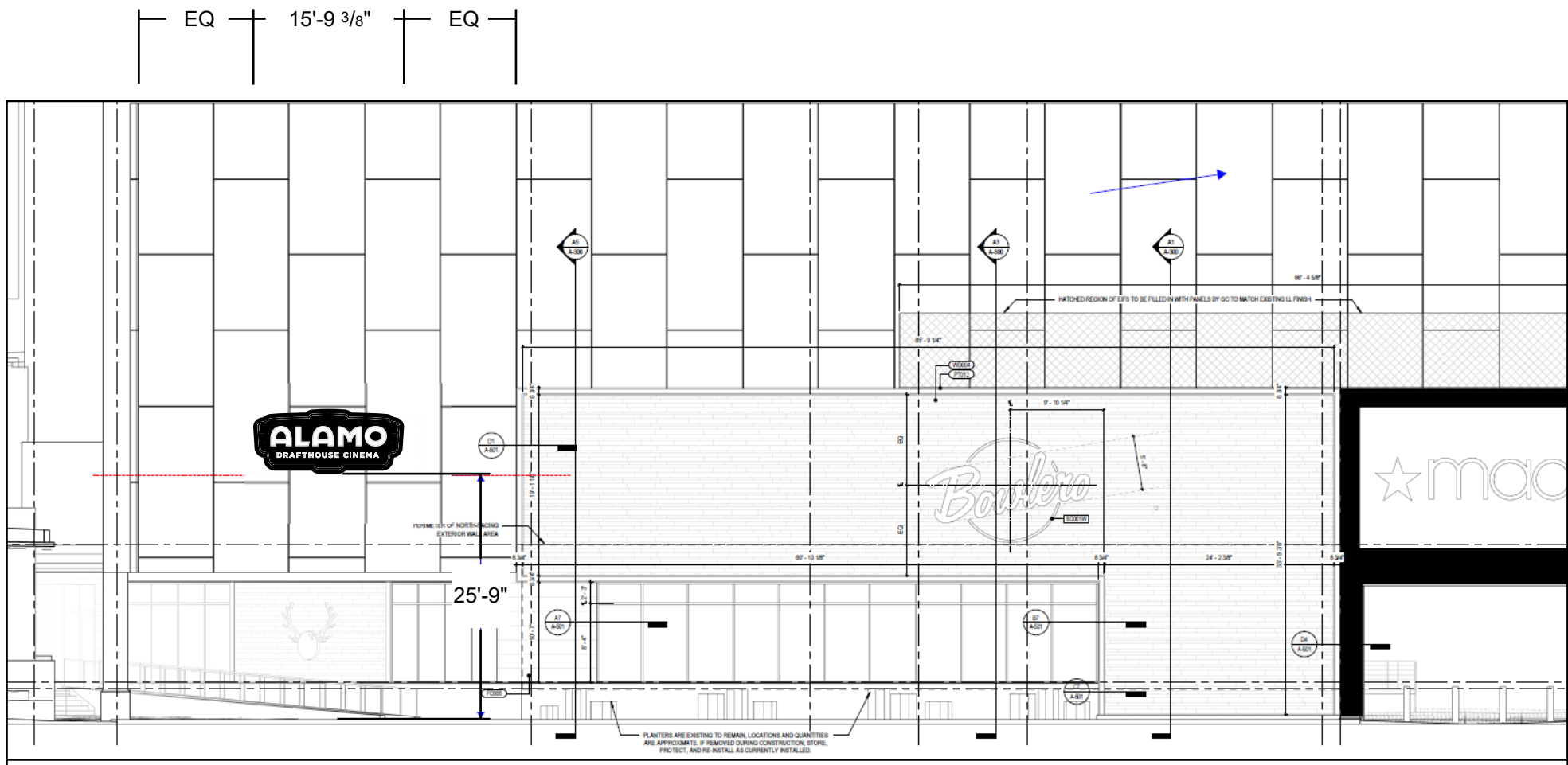

- NOTES:**
- SIGN LOCATIONS MAY VARY SLIGHTLY BASED ON ENGINEERING.
 - MOUNTING TO BE DETERMINED BASED ON DETAILED SURVEY OF BUILDING CONSTRUCTION AND ENGINEERING.

FIELD SURVEY REQUIRED

All dimensions are estimated and subject to change upon confirmation of field conditions.



DRAWING NO.

E047829

DATE OF LAST CHANGE:

02/20/25

ADDITIONAL INSTALL NOTES:

CONSULTANT:

J WELCH

PROJECT MANAGER:

D BELINGER

DESIGNER:

B PARRISH

FILE LOCATION:
COMPANY/ALAMO DRAFTHOUSE CINEMA/DOCUMENTS/PROJECTS/CURRENT
PROJECTS/CA/ E047829-SANTA CLARA/11 PRODUCTION FILES

PAGE:

4

ELEV

REVISION NO.

4

2855 STEVENS CREEK BLVD., SANTA CLARA, CA 95050

ASG
ADVANCE SIGN GROUP



800.861.8006
ADVANCESIGNGROUP.COM

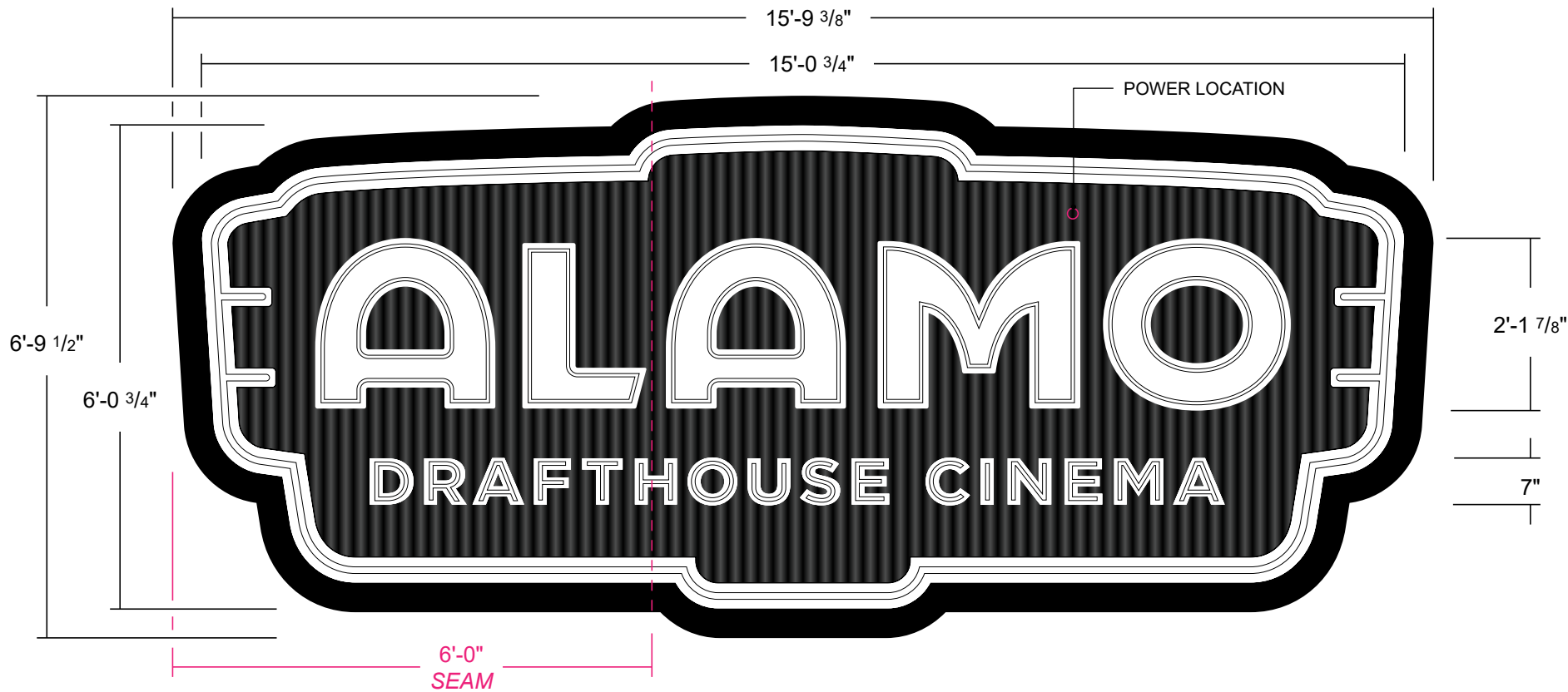

WALL CABINET

QTY: (1) ONE REQUIRED

SIGN DETAIL:

- 1 CUSTOM FABRICATED ALUMINUM CABINET PAINTED **FLAT C1 & GLOSS C2**.
- 2 .040" ALUMINUM OPEN FACE BORDER CHANNEL RETURNS PAINTED INSIDE **FLAT C1** / OUTSIDE **FLAT C1**.
- 3 1/8" ACM BACK PAINTED OUTSIDE **C2** / INSIDE **C2**.
- 4 1" SHOULDER CUT 7328 WHITE ACRYLIC PUSH THRU COPY & 2ND SURFACE DIFFUSER.
- 5 ADDITIONAL ALUMINUM ANGLE SUPPORT AS NEEDED.
- 6 WHITE 7100K LEDS AS REQUIRED (QTY & PLACEMENT DETERMINED BY SIGN SIZE)
- 7 REMOTE 120V-277V POWER SUPPLIES MOUNTED INSIDE UL METAL BOX W/ DISCONNECT SWITCH.
- 8 UL LISTED/RECOGNIZED 18 AWG/PLTC WIRING AND FIXTURES GOING TO POWER SUPPLIES. **SIGN TO HAVE 8'-0" WHIP.**

- 9 MOUNTING TBD PENDING DETAILED SURVEY AND STAMPED ENGINEER DRAWINGS PAINTED TO MATCH **EXISTING BUILDING**.
- 10 BLOCKING REQUIREMENTS TBD PENDING DETAILED SURVEY AND STAMPED ENGINEER DRAWINGS.
- 11 WALL CONSTRUCTION IS EIFS OVER METAL STUD FRAMING.
- 12 WEEP HOLES W/ LIGHT BAFFLE.
- 13 .063" ALUMINUM BORDER INSERT PAINTED **GLOSS C2**.



GENERAL NOTES:

- NO VISIBLE WIRING, ELECTRICAL, FASTENERS, HARDWARE, RACEWAYS, LIGHT LEAKS, OR LABELS ALLOWED. (IF NECESSARY, VISIBLE HARDWARE TO BE PAINTED TO MATCH BUILDING.)
- WEEP HOLES TO HAVE BAFFLES.
- NO "OIL CANNING" ALLOWED.
- STAND-OFFS AND VISIBLE CONDUIT TO BE PAINTED TO MATCH EXISTING BUILDING.

SECTION DETAIL

SCALE: 1" = 1'-0"

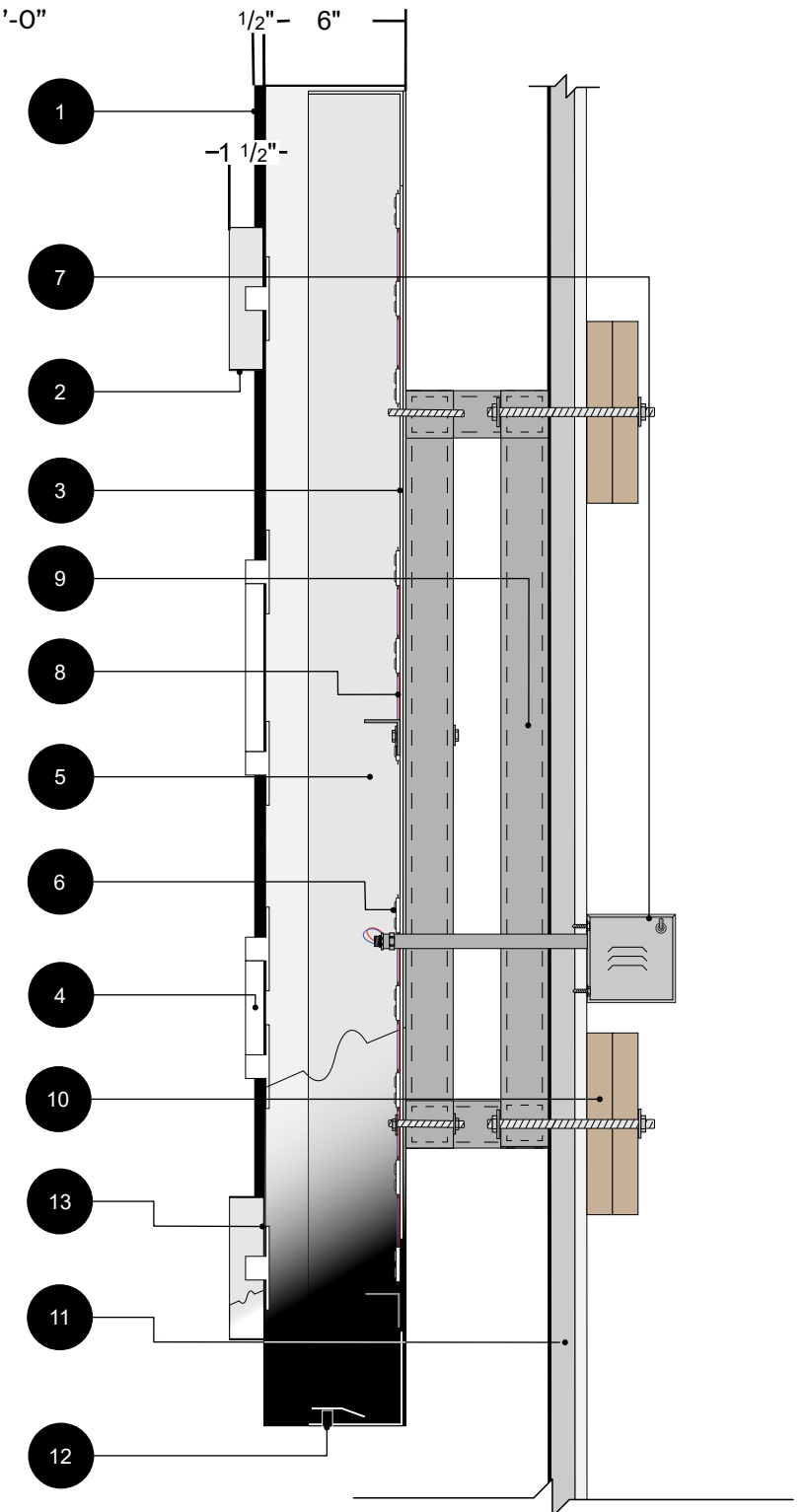

INSTALLATION NOTES 1: USE NON-CORROSIVE HARDWARE AND SEAL ALL EXTERIOR FACADE PENETRATIONS WATERTIGHT.

INSTALLATION NOTES 2: ONE (1) DEDICATED 120VAC CIRCUIT BY OTHERS REQUIRED WITHIN 5' OF CENTER OF SIGN. THIS SIGN IS INTENDED TO BE INSTALLED IN ACCORDANCE WITH THE REQUIREMENTS OF ARTICLE 600 OF THE NATIONAL ELECTRICAL CODE AND/OR OTHER APPLICABLE CODES. THIS INCLUDES PROPER GROUNDING AND BONDING.

INSTALLATION NOTES 3: GC TO PROVIDE ADEQUATE WOOD OR METAL BLOCKING IN CORRELATION W/ FACADE FRAMING AS REQUIRED.



2855 STEVENS CREEK BLVD., SANTA CLARA, CA 95050

DRAWING NO.

E047829

DATE OF
LAST CHANGE:

02/20/25

ADDITIONAL INSTALL NOTES:

REVISION NO.

4

FILE LOCATION:

COMPANY/ALAMO DRAFTHOUSE CINEMA/DOCUMENTS/PROJECTS/CURRENT
PROJECTS/CA/ E047829-SANTA CLARA/11 PRODUCTION FILES

CONSULTANT:

J WELCH

PROJECT MANAGER:

D BELINGER

DESIGNER:

B PARRISH

PAGE:

5

ASG

ADVANCE SIGN GROUP



800.861.8006

ADVANCESIGNGROUP.COM

INTERIOR FLOOR PLAN

OVERALL FLOOR PLAN _ LEVEL 2 - MAIN

SCALE: NTS

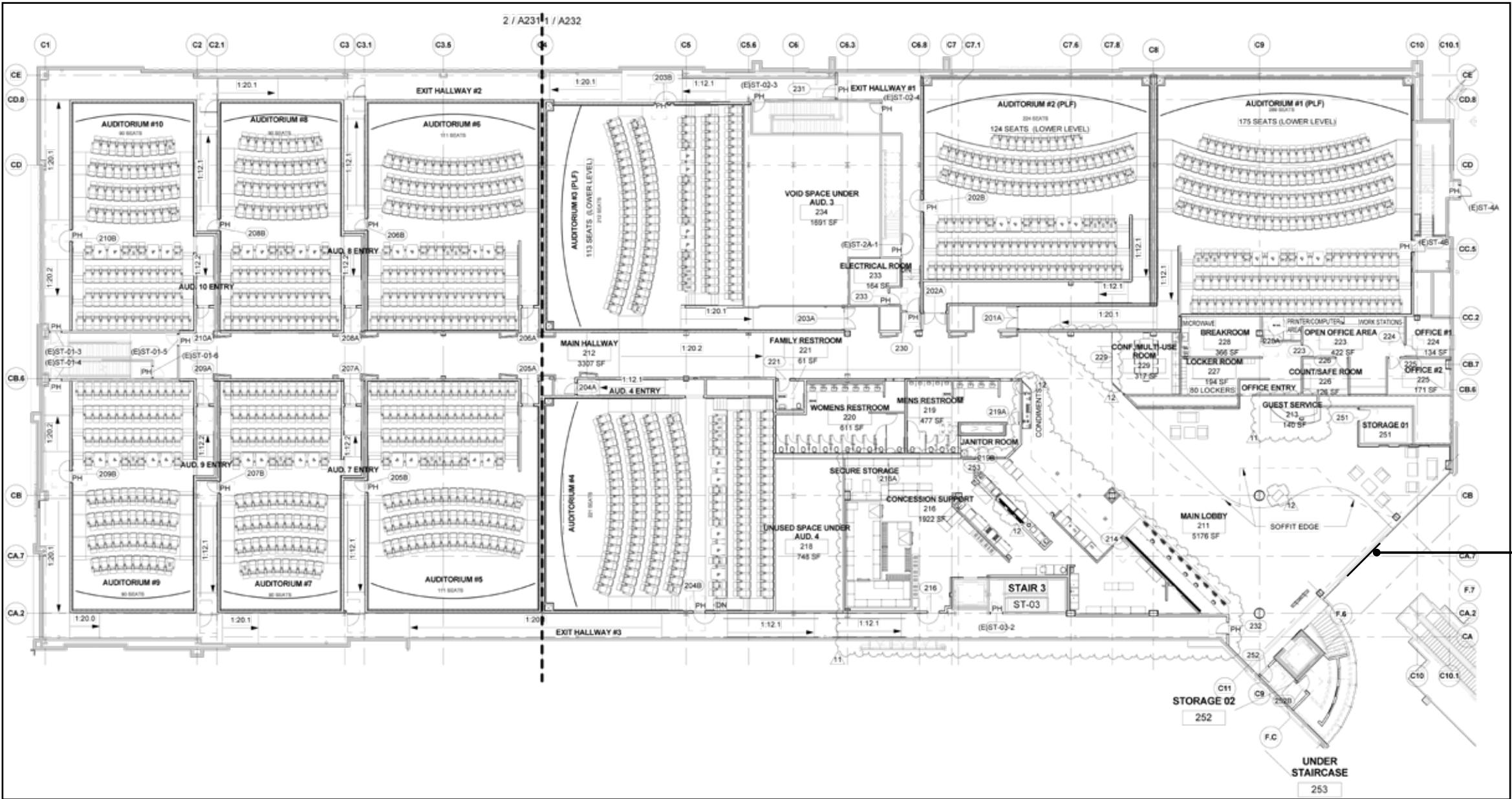

FIELD SURVEY REQUIRED

All dimensions are estimated and subject to change upon confirmation of field conditions.

3.0



DRAWING NO.

E047829

DATE OF LAST CHANGE:

02/20/25

REVISION NO.

4

ADDITIONAL INSTALL NOTES:

FILE LOCATION:
COMPANY/ALAMO DRAFTHOUSE CINEMA/DOCUMENTS/PROJECTS/CURRENT
PROJECTS/CA/ E047829-SANTA CLARA/11 PRODUCTION FILES

CONSULTANT:

J WELCH
PROJECT MANAGER:
D BELINGER
DESIGNER:
B PARRISH

PAGE:

7

2855 STEVENS CREEK BLVD., SANTA CLARA, CA 95050

ASG
ADVANCE SIGN GROUP



800.861.8006
ADVANCESIGNGROUP.COM

INTERIOR ELEVATION

ELEVATION DETAIL _ 3.0

SCALE: 1/4" = 1'-0"

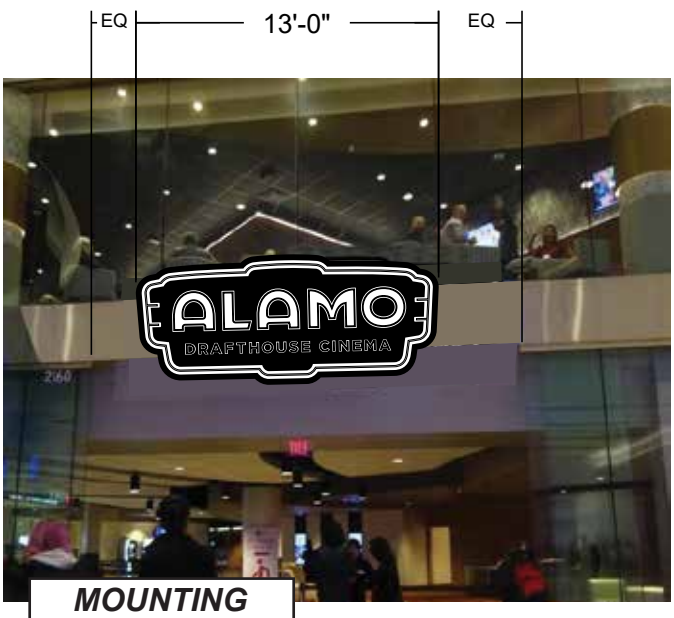
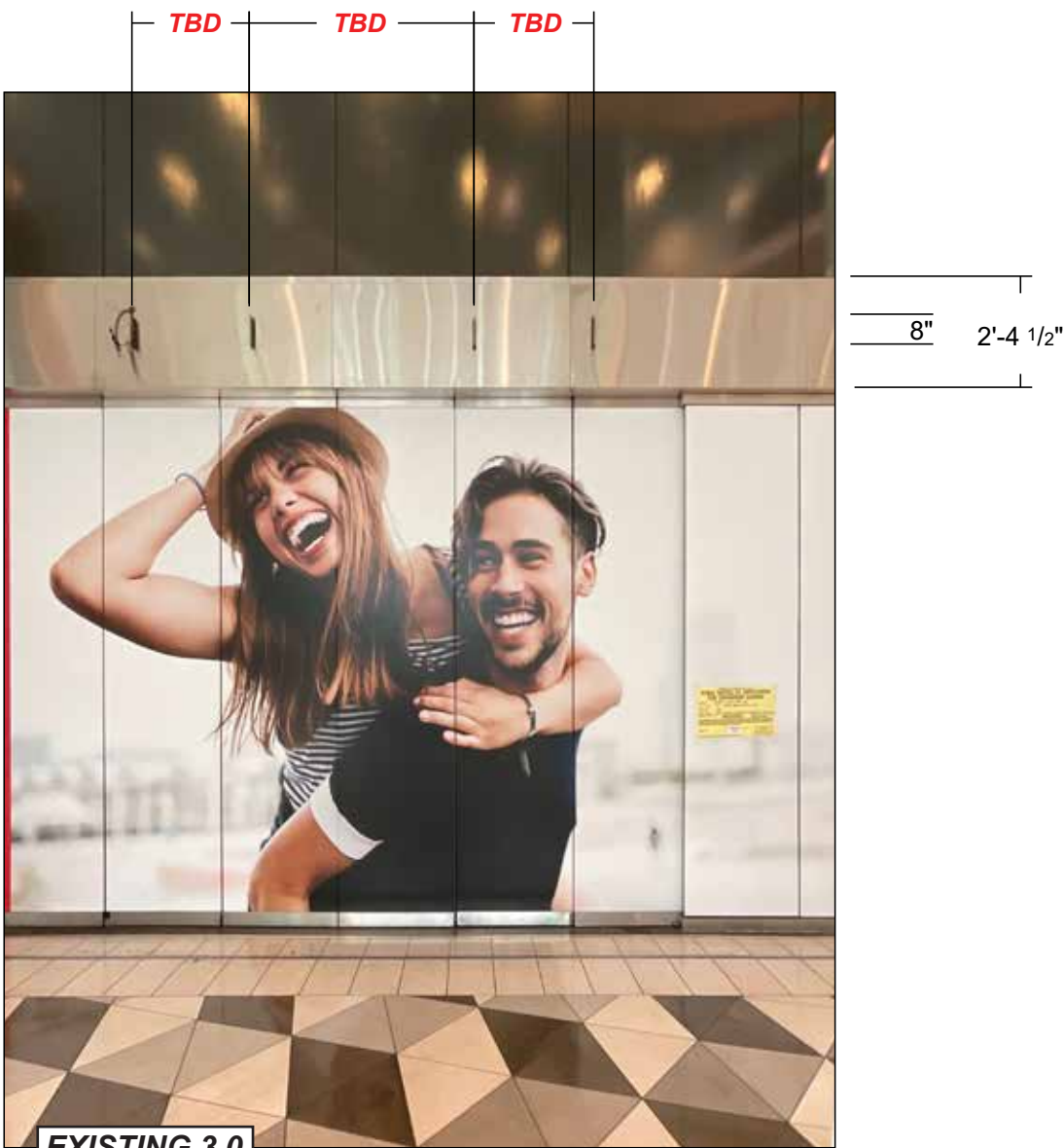

- NOTES:**
- DETAILED SURVEY OF EXISTING MOUNTING TABS NEEDED.
 - HEIGHT
 - THICKNESS
 - DEPTH
 - SUBSTRATE
 - SPACING

FIELD SURVEY REQUIRED

All dimensions are estimated and subject to change upon confirmation of field conditions.



2855 STEVENS CREEK BLVD., SANTA CLARA, CA 95050

DRAWING NO.
E047829

ELEV

DATE OF
LAST CHANGE:
02/20/25

REVISION NO.
4

ADDITIONAL INSTALL NOTES:

FILE LOCATION:
COMPANY/ALAMO DRAFTHOUSE CINEMA/DOCUMENTS/PROJECTS/CURRENT
PROJECTS/CA/ E047829-SANTA CLARA/11 PRODUCTION FILES

CONSULTANT:
J WELCH
PROJECT MANAGER:
D BELINGER
DESIGNER:
B PARRISH

PAGE:

6

ASG
ADVANCE SIGN GROUP



800.861.8006
ADVANCESIGNGROUP.COM

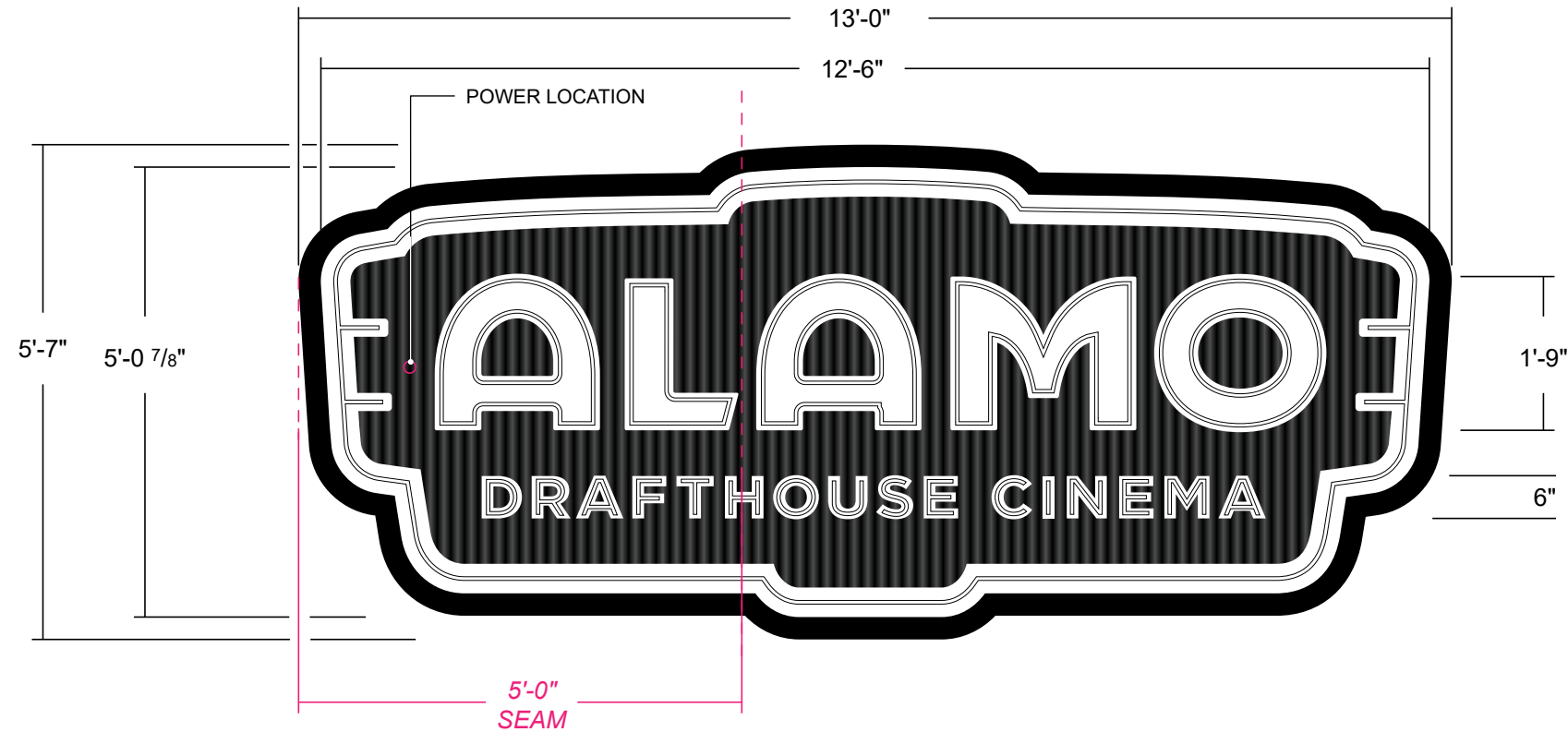

SECTION DETAIL

SCALE: 1" = 1'-0"

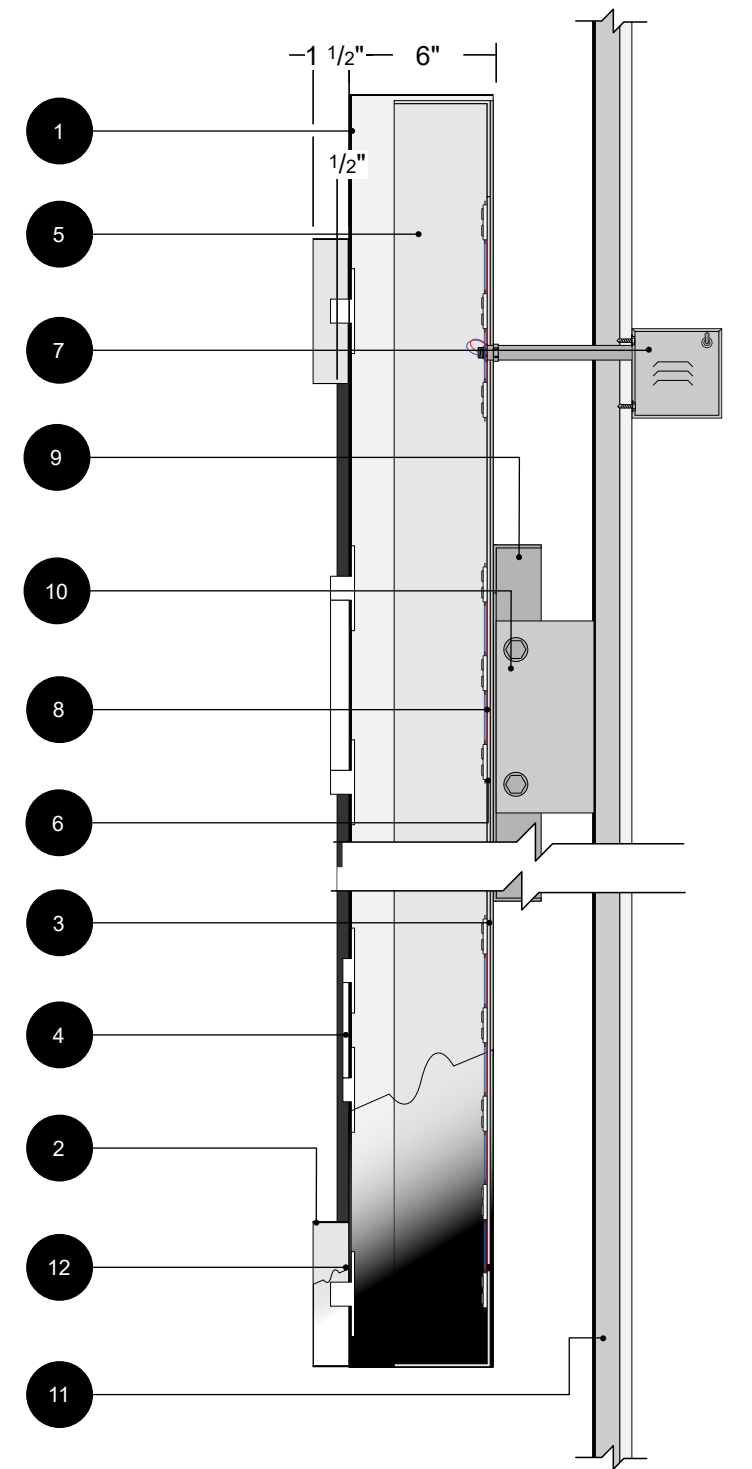

INTERIOR WALL CABINET

SCALE: 3/8"=1'-0"

QTY: (1) ONE REQUIRED

72.58 FT²

SIGN DETAIL:

- 1

CUSTOM FABRICATED ALUMINUM CABINET PAINTED **FLAT C1 & GLOSS C2**.
- 2

.040" ALUMINUM OPEN FACE BORDER CHANNEL RETURNS PAINTED INSIDE **FLAT C1** / OUTSIDE **FLAT C1**.
- 3

1/8" ACM BACK PAINTED OUTSIDE **C2** / INSIDE **C2**.
- 4

1" SHOULDER CUT 7328 WHITE ACRYLIC PUSH THRU COPY & 2ND SURFACE DIFFUSER.
- 5

ADDITIONAL ALUMINUM ANGLE SUPPORT AS NEEDED.
- 6

WHITE 7100K LEDS AS REQUIRED (QTY & PLACEMENT DETERMINED BY SIGN SIZE)
- 7

REMOTE 120V-277V POWER SUPPLIES MOUNTED INSIDE UL METAL BOX W/ DISCONNECT SWITCH.
- 8

UL LISTED/RECOGNIZED 18 AWG/PLTC WIRING AND FIXTURES GOING TO POWER SUPPLIES. **SIGN TO HAVE 8'-0" WHIP.**
- 9

2"X2"X3/16" ALUMINUM ANGLE MOUNTING FRAME **(TO BE CONFIRMED BY ENGINEER)**
- 10

MECHANICALLY FASTEN SIGN VIA MOUNTING ANGLE FRAME TO EXISTING STEEL TABS. **(TO BE CONFIRMED BY ENGINEER)**
- 11

WALL CONSTRUCTION TBD PENDING DETAIL SURVEY.
- 12

.063" ALUMINUM BORDER INSERT PAINTED **GLOSS C2**.



GENERAL NOTES:

- NO VISIBLE WIRING, ELECTRICAL, FASTENERS, HARDWARE, RACEWAYS, LIGHT LEAKS, OR LABELS ALLOWED. (IF NECESSARY, VISIBLE HARDWARE TO BE PAINTED TO MATCH BUILDING.)
- WEEP HOLES TO HAVE BAFFLES.
- NO "OIL CANNING" ALLOWED.
- STAND-OFFS AND VISIBLE CONDUIT TO BE PAINTED TO MATCH EXISTING BUILDING.

INSTALLATION NOTES 1: USE NON-CORROSIVE HARDWARE AND SEAL ALL EXTERIOR FACADE PENETRATIONS WATERTIGHT.

INSTALLATION NOTES 2: ONE (1) DEDICATED 120VAC CIRCUIT BY OTHERS REQUIRED WITHIN 5' OF CENTER OF SIGN. THIS SIGN IS INTENDED TO BE INSTALLED IN ACCORDANCE WITH THE REQUIREMENTS OF ARTICLE 600 OF THE NATIONAL ELECTRICAL CODE AND/OR OTHER APPLICABLE CODES. THIS INCLUDES PROPER GROUNDING AND BONDING.

INSTALLATION NOTES 3: GC TO PROVIDE ADEQUATE WOOD OR METAL BLOCKING IN CORRELATION W/ FACADE FRAMING AS REQUIRED.



2855 STEVENS CREEK BLVD., SANTA CLARA, CA 95050

DRAWING NO.	DATE OF LAST CHANGE:	ADDITIONAL INSTALL NOTES:
E047829	02/20/25	
3.0	REVISION NO.	FILE LOCATION: COMPANY/ALAMO DRAFTHOUSE CINEMA/DOCUMENTS/PROJECTS/CURRENT PROJECTS/CA/ E047829-SANTA CLARA/11 PRODUCTION FILES
4	4	

CONSULTANT: J WELCH PROJECT MANAGER: D BELINGER DESIGNER: B PARRISH
PAGE: 8



800.861.8006
ADVANCESIGNGROUP.COM

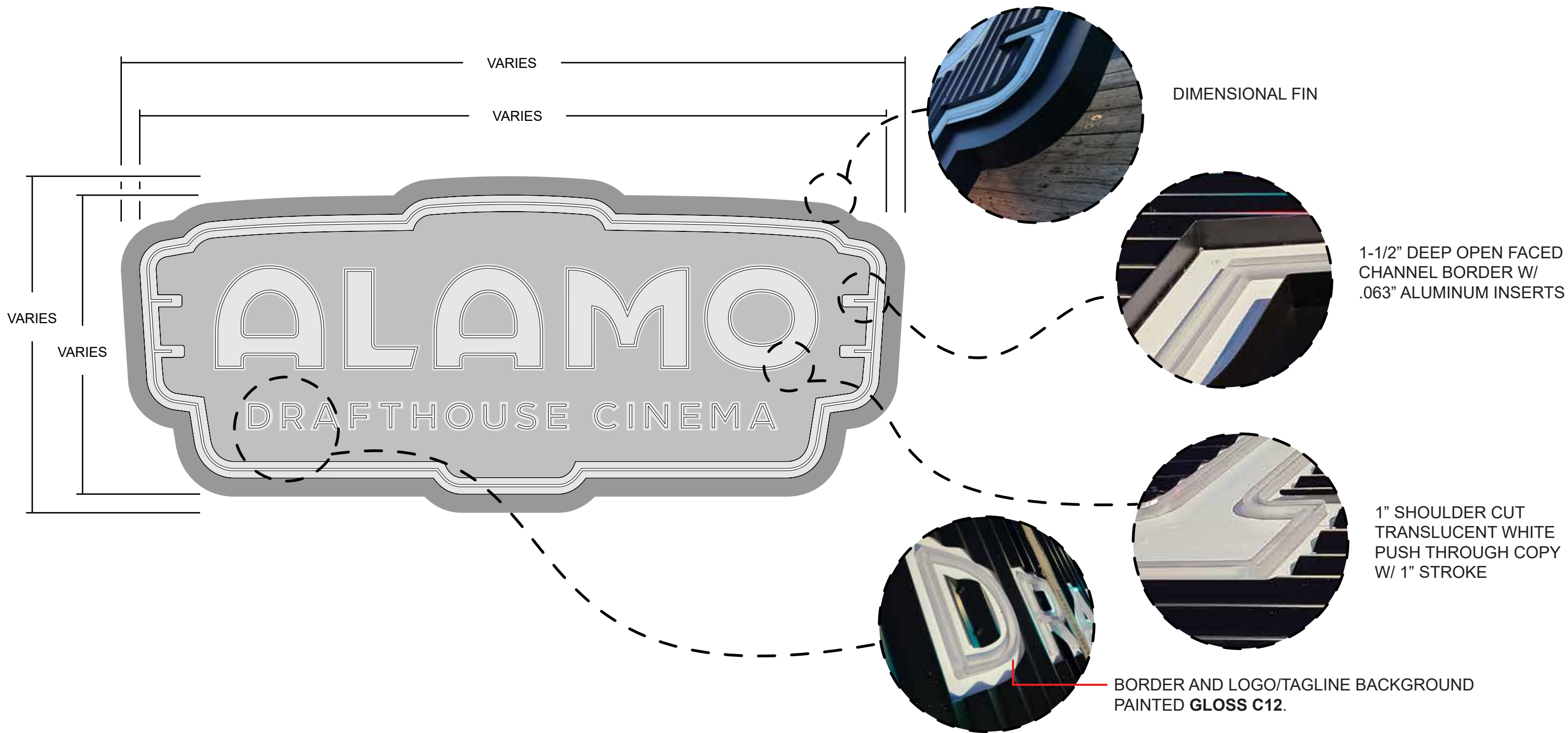

DRAWING NO.
E047829

DATE OF
LAST CHANGE:
02/20/25

ADDITIONAL INSTALL NOTES:

CONSULTANT:
J WELCH
PROJECT MANAGER:
D BELINGER
DESIGNER:
B PARRISH



REVISION NO.
4

FILE LOCATION:
COMPANY/ALAMO DRAFTHOUSE CINEMA/DOCUMENTS/PROJECTS/CURRENT
PROJECTS/CA/ E047829-SANTA CLARA/11 PRODUCTION FILES

PAGE:

9

ASG
ADVANCE SIGN GROUP



800.861.8006
ADVANCESIGNGROUP.COM